





Fulham Road, SW3 6SH
£630 pw



 2 Bedrooms  2 Bathrooms  1 Reception

Cameron Pearson presents this well proportioned two bedroom apartment set on the 2nd floor (with lift) of this sought after portered building on Fulham Road. Situated at the back of the building, this quiet apartment overlooks private gardens and comprises a spacious reception, separate fully-fitted kitchen, two double bedroom and two bathrooms. Ideally located on Fulham Road, opposite Pelham Crescent, you are a short walk to both South Kensington and the King's Road, with their host of shopping, dining and amenities. South Kensington Underground station (Piccadilly Line and Circle & District Lines) is the closest station. Please contact Cameron Pearson for further details and to arrange a viewing.

Fulham Road, SW3

731sqft / 67.9sqm

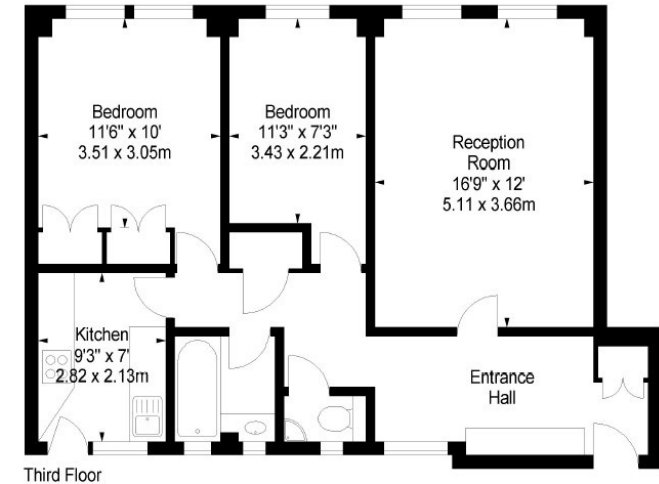

- Porter
- No Lower Ground
- No Walk Ups
- Lift
- Quiet Road



Fulham Road, SW3 6SH

£630 pw



► View this property at <https://www.cameronpearson.co.uk/property/redirect/55721>

Energy Efficiency Rating

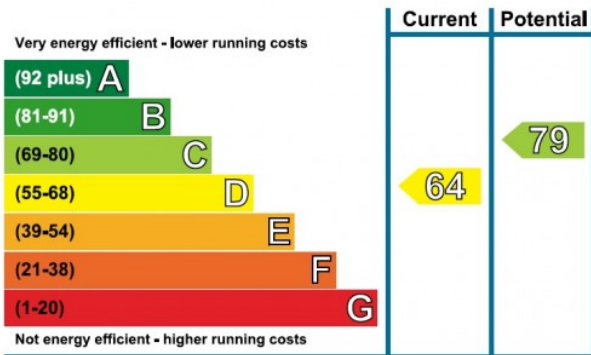

The graph shows the current energy efficiency of your home.

The higher the rating the lower your fuel bills are likely to be.

The potential rating shows the effect of undertaking the recommendations on page 3.

The average energy efficiency rating for a dwelling in England and Wales is band D (rating 60).

The EPC rating shown here is based on standard assumptions about occupancy and energy use and may not reflect how energy is consumed by individual occupants.

We are Cameron Pearson an estate agency doing business in a refreshing, forward-thinking and efficient manner. We pride ourselves on having the best quality property and providing an unmatched tailored service.

If you would like more details on this property, or any other properties in our portfolio please do not hesitate to contact us.

111a Walton Street
Knightsbridge
London
SW3 2HP

Tel: 020 7373 3933

Email: enquiries@cameronpearson.co.uk

